

Montageanleitung für den Ausziehtischbeschlag

“TopFlex”
Assembly instructions
for pull-out table “TopFlex”
Art.-Nr. 005123...

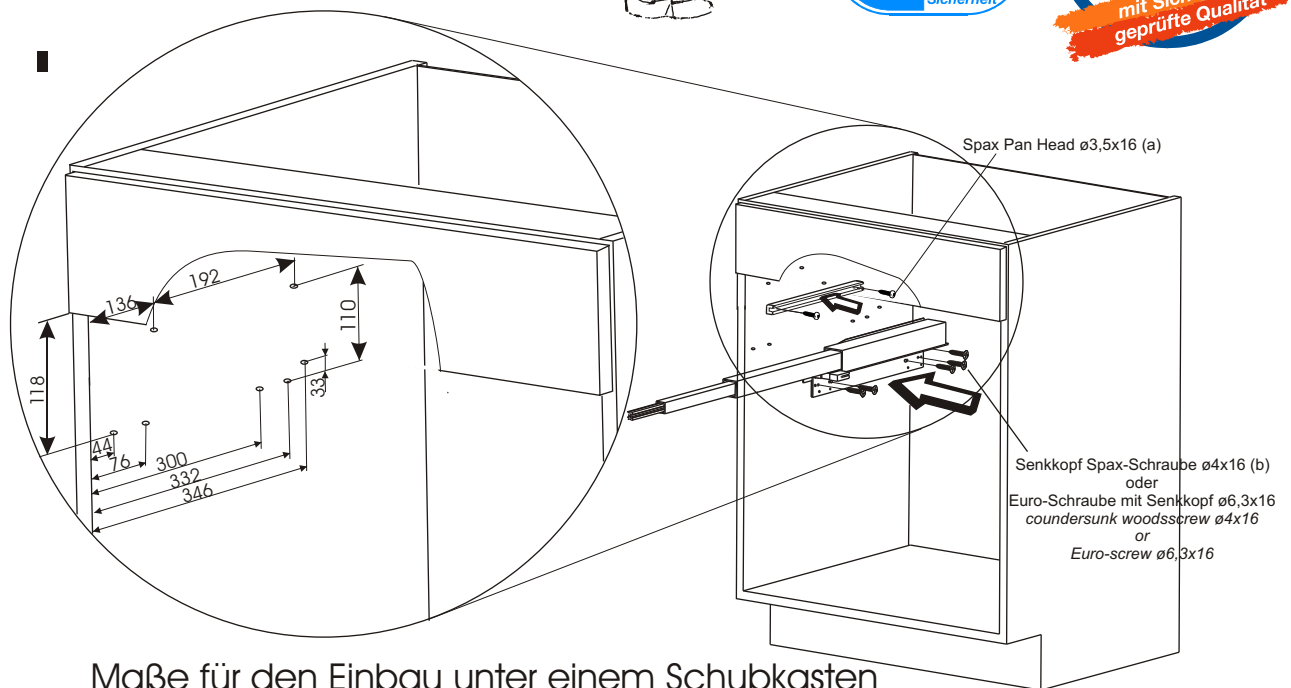

1.



Maße für den Einbau unter einem Schubkasten
Drilling pattern for installation below a drawer

min. Korpustiefe 500mm
min. carcass depth 500mm

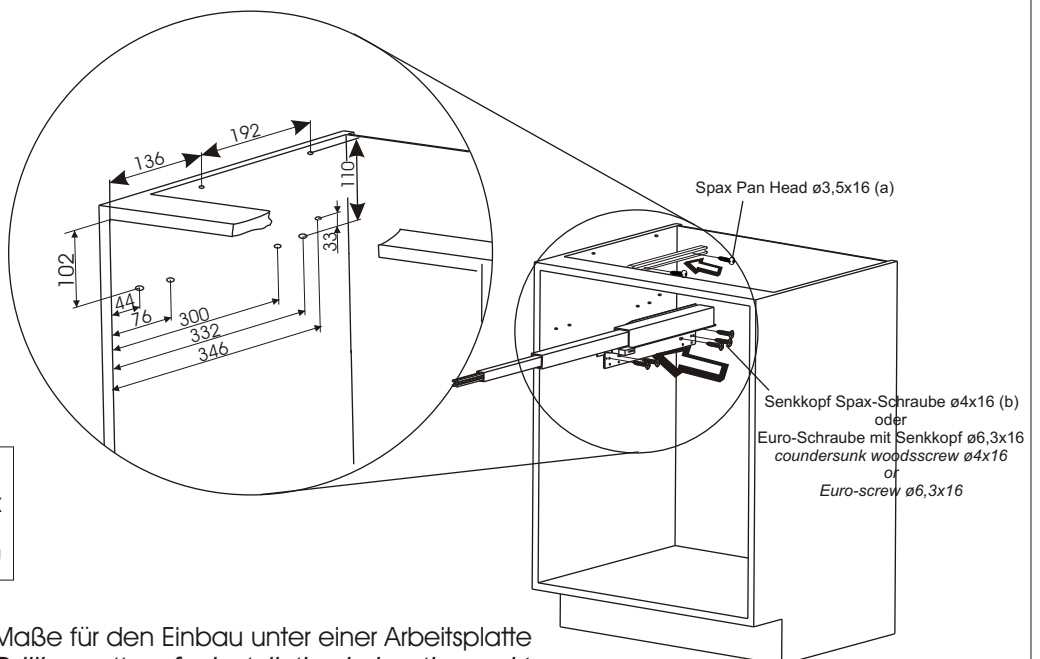
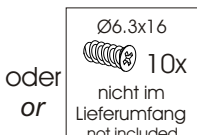
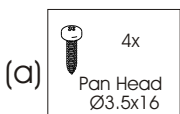

Maße für den Einbau unter einer Arbeitsplatte
Drilling pattern for installation below the worktop

2. Zentrierung für Tischplatten Centre for table-panels

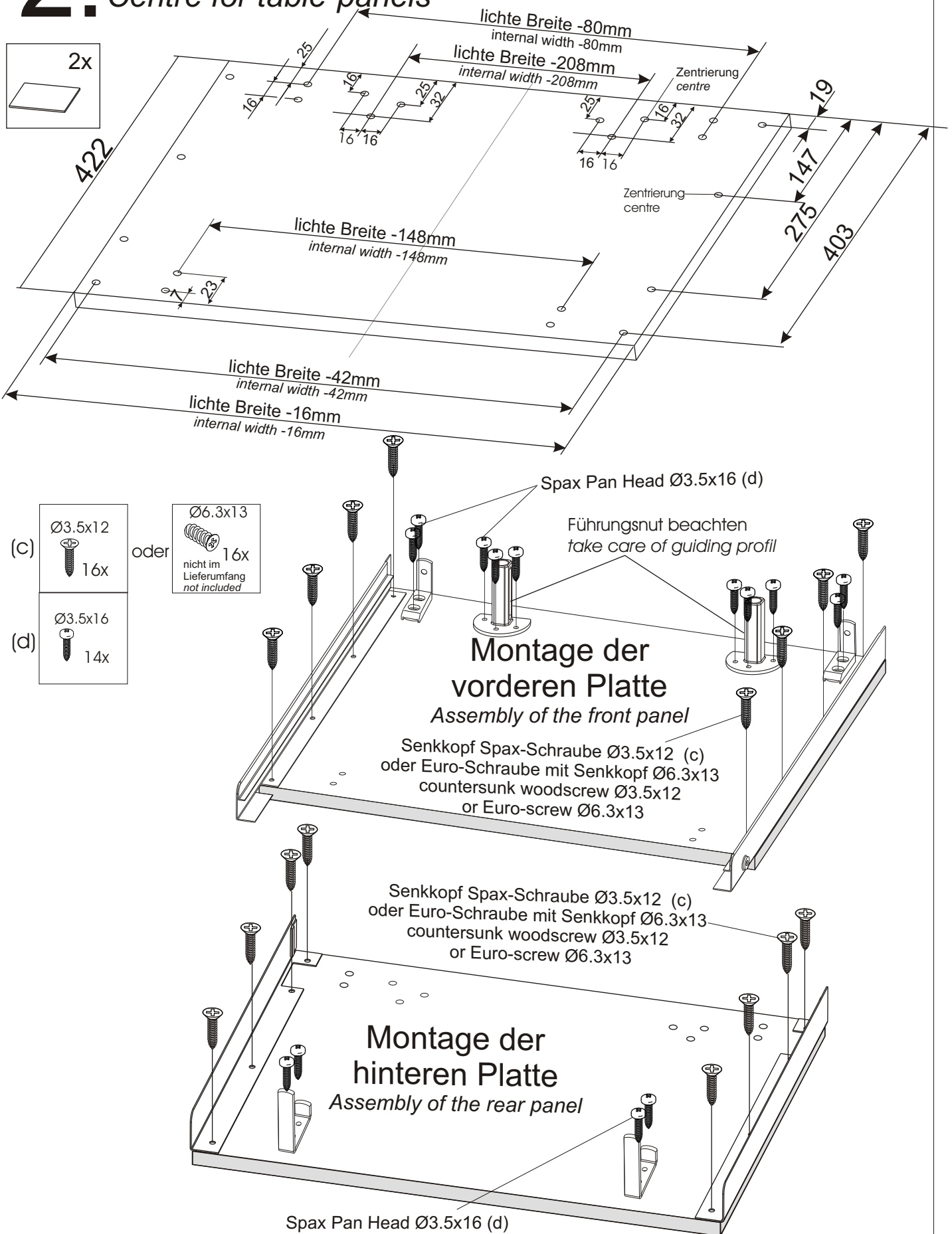

3. Vormontage der Front Pre-assembly of door

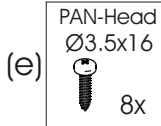

Fronthöhe 115 bis 123 mm:
entlang der Markierung kürzen
Height of flap 115-123 mm:
shorten the fixing tube where marked

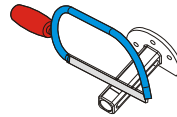

Maß "C"	Fuge Joint	
65	3mm	16 er Tisch- platten table panel
63	5mm	
68	3mm	19 er Tisch- platten table panel
66	5mm	

Griffschraubenköpfe müssen versenkt sein
The screw heads have to be flush inside the handle

Auf Leichtgängigkeit
achten
Please observe free-moving
of the front blind

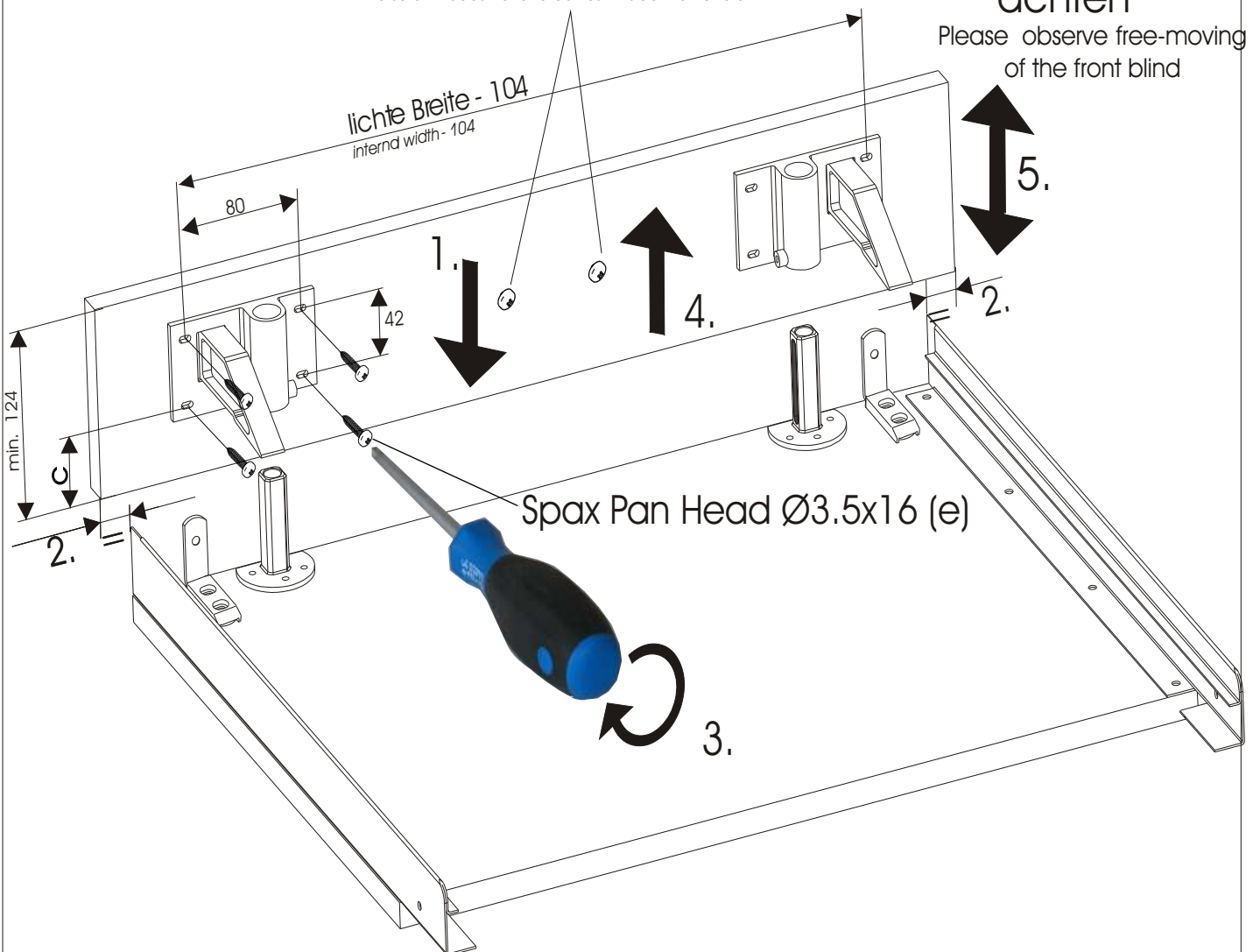

4. Einsetzen der hinteren Platte Put in the rear panel

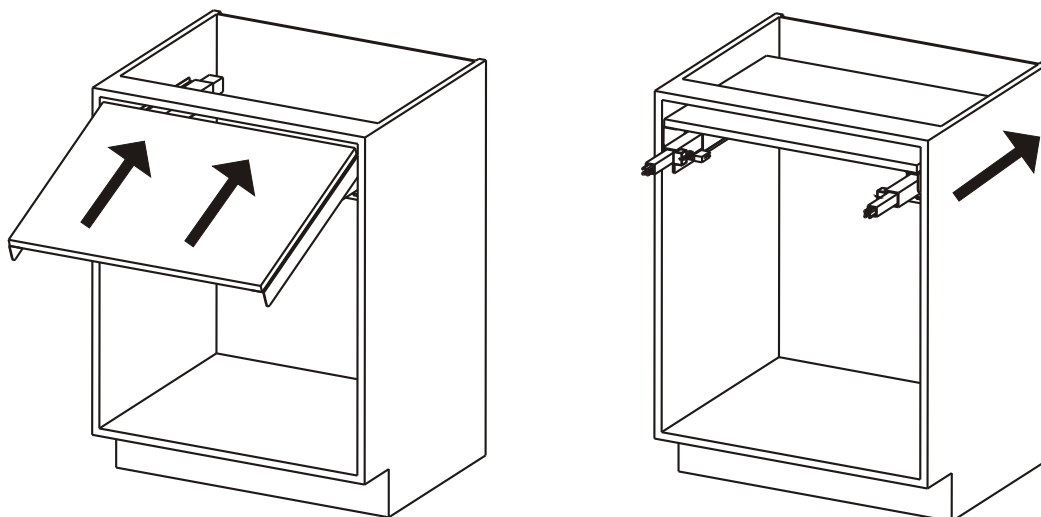

5. Einsetzen der vorderen Platte Put in the front panel

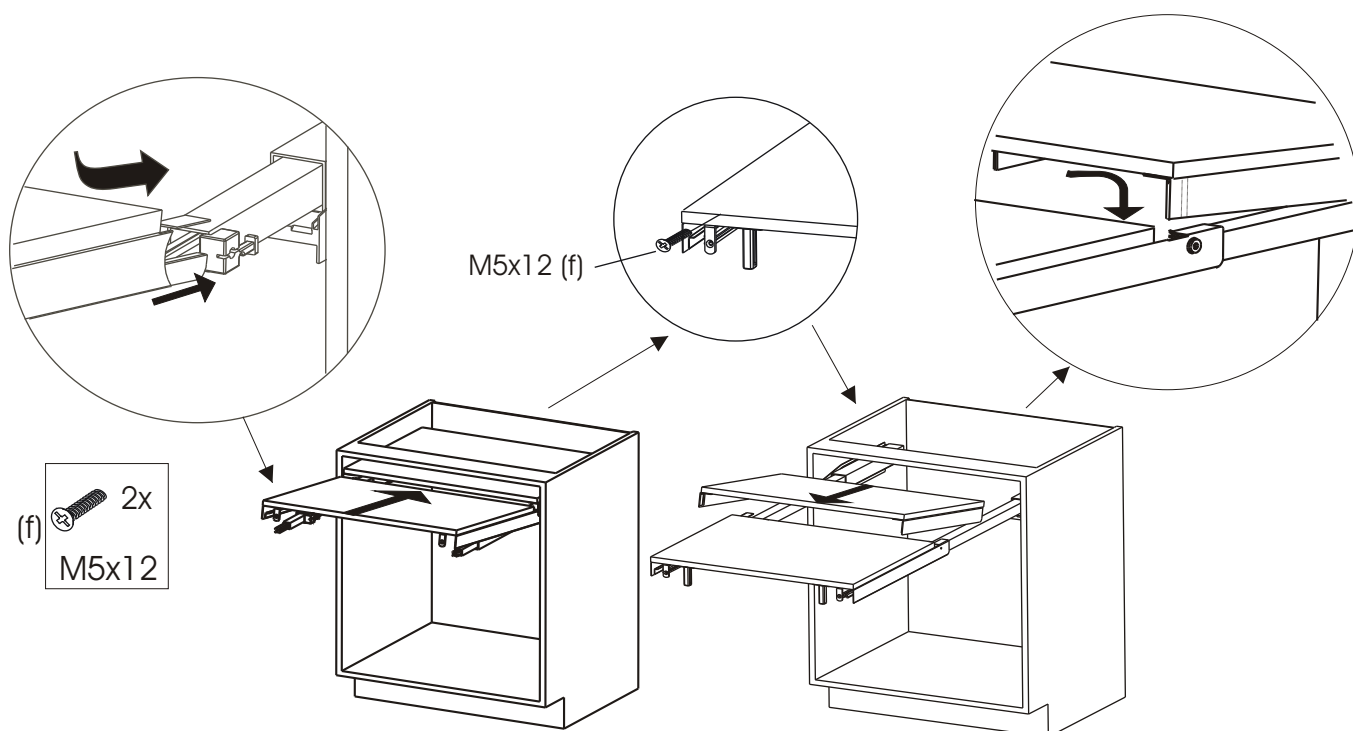

6.

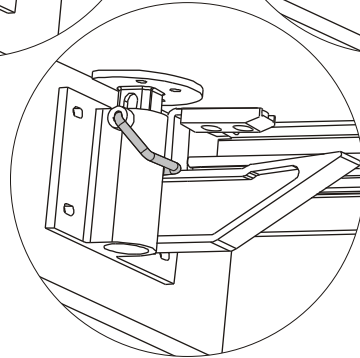
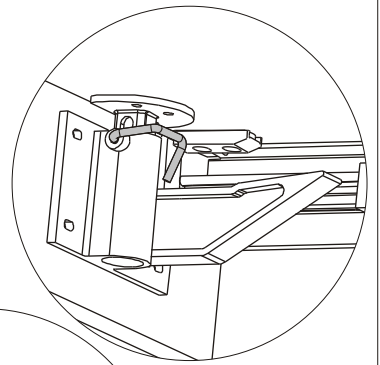
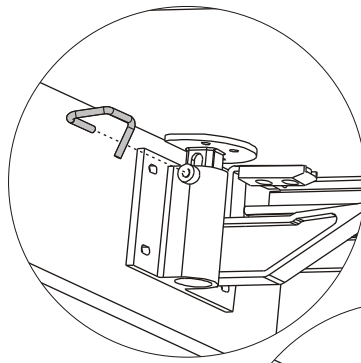
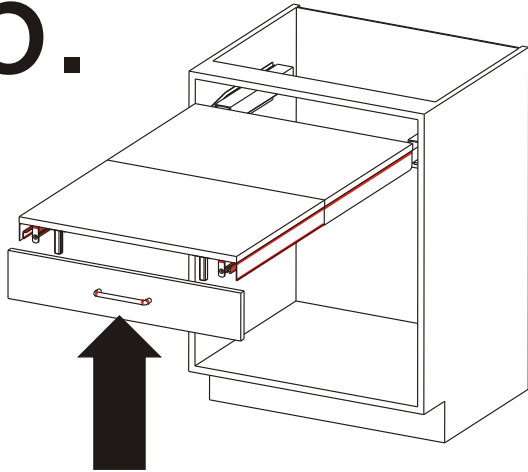

Justieranleitung *Adjustment instruction*

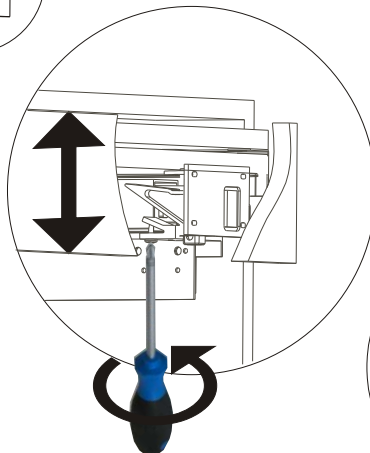
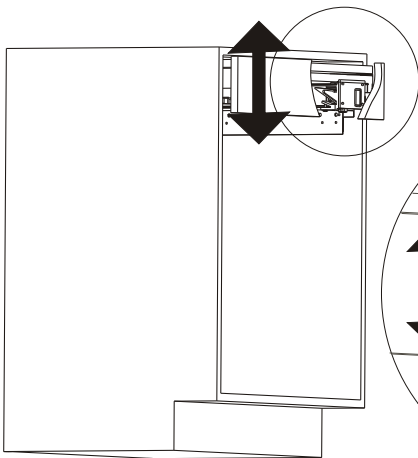
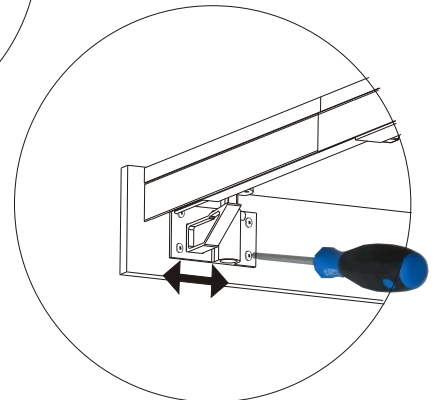
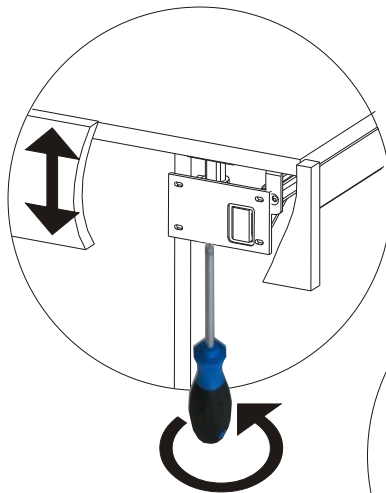
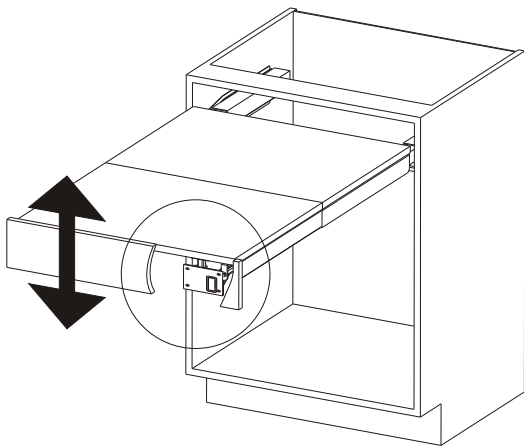

bei Kollision: Stift einsetzen !
in case of collision: insert pin

